

# Corner Type Building

## Assembly Guide

### Tools Required

You will need a craft knife + good quality PVA wood Glue

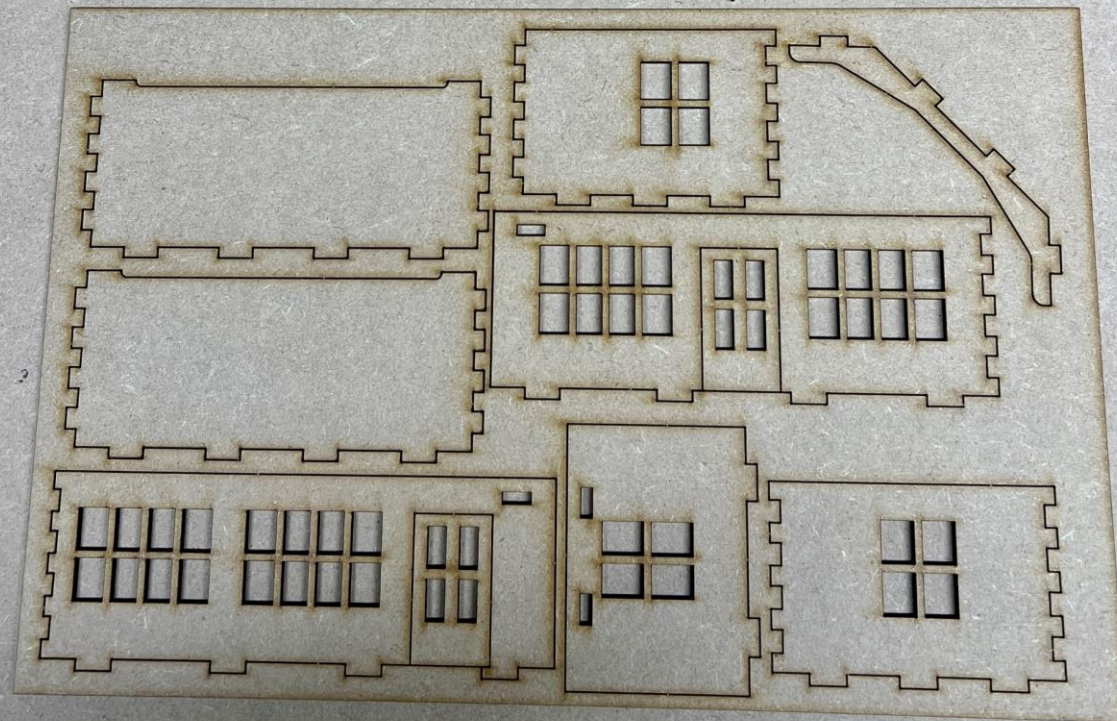



Glue the four together at 90 deg &  
allow the glue to set

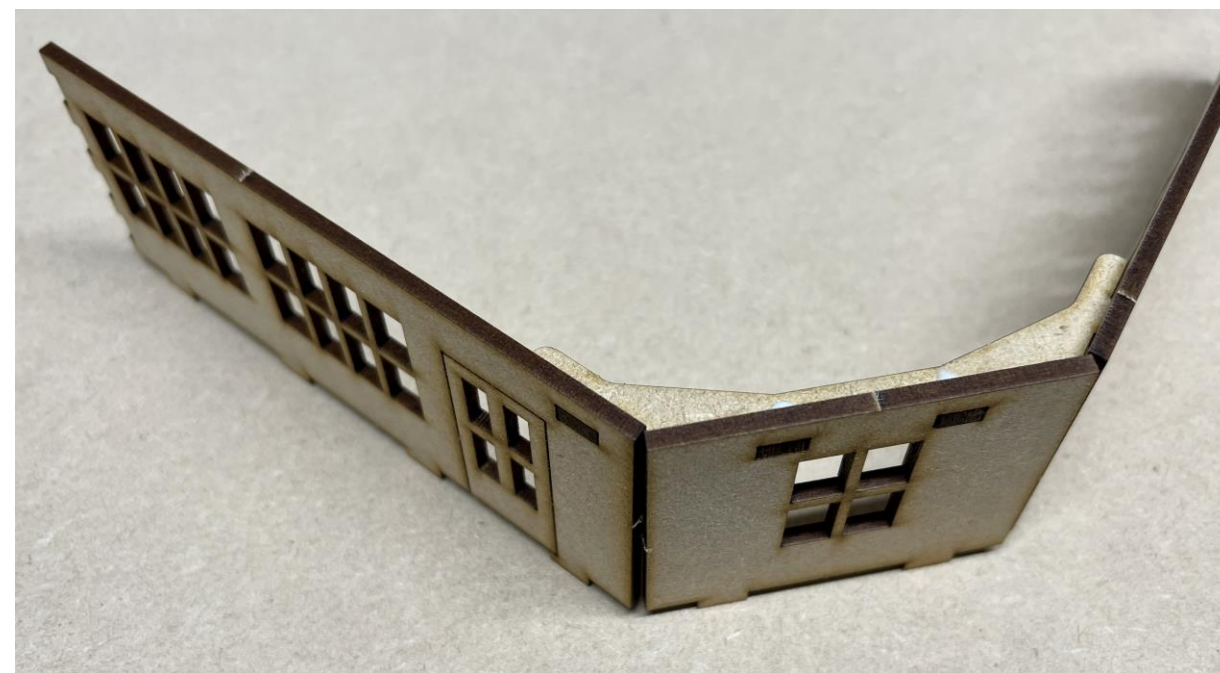
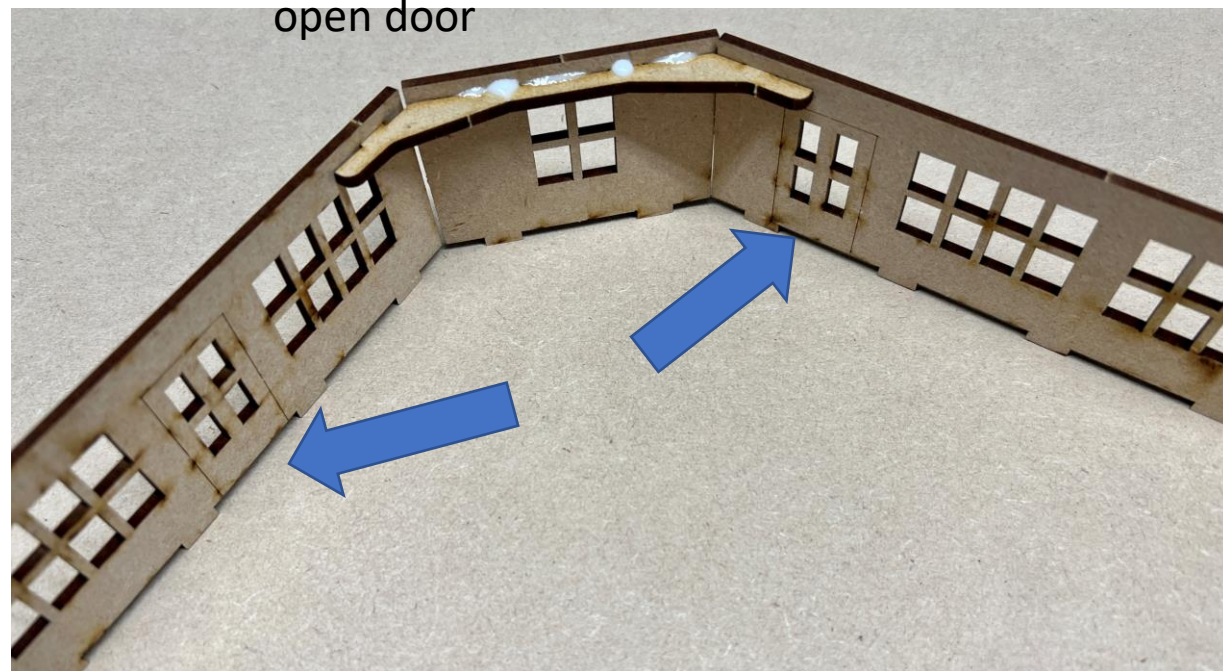



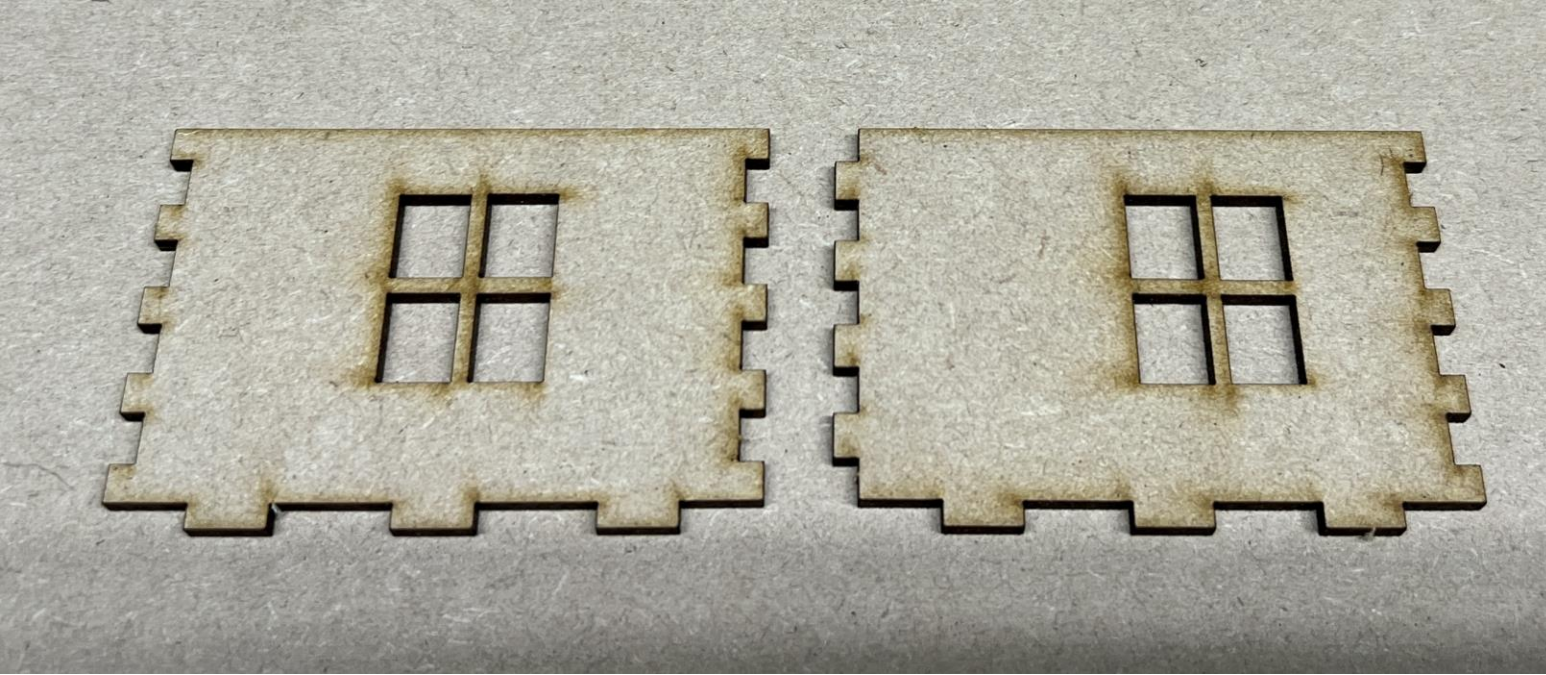

Glue the two sides  
together at 90 deg & allow  
the glue to partially set

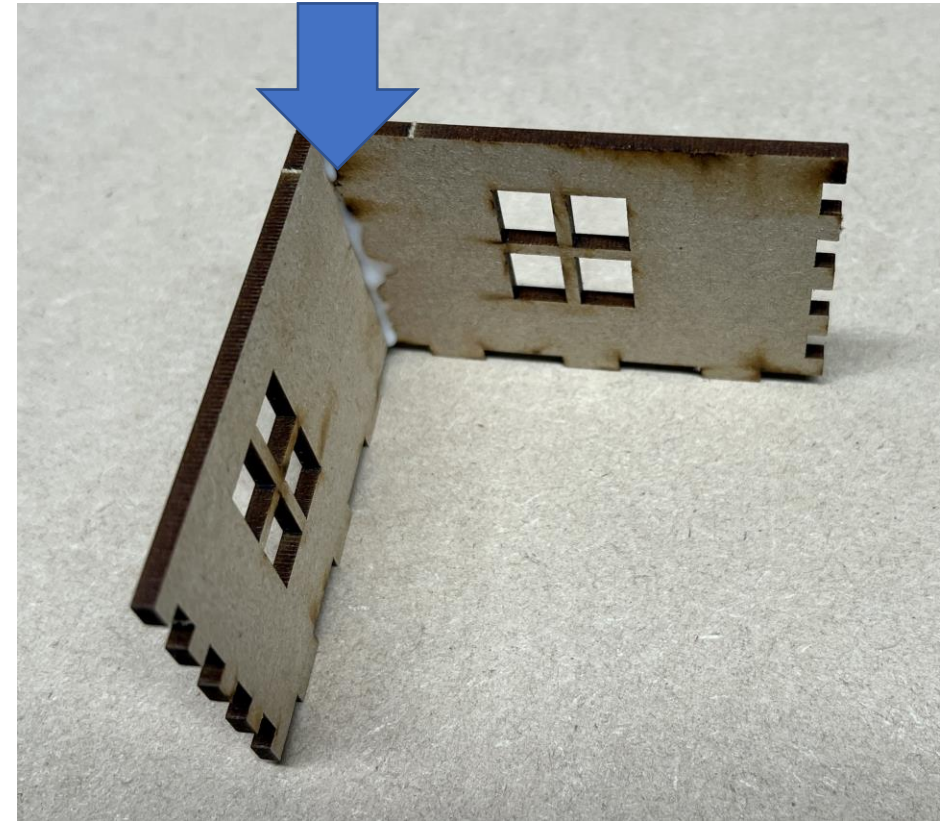



Glue both assemblies  
to the base





The doors are held in by 3 tabs,  
they be taken out if you want a  
open door

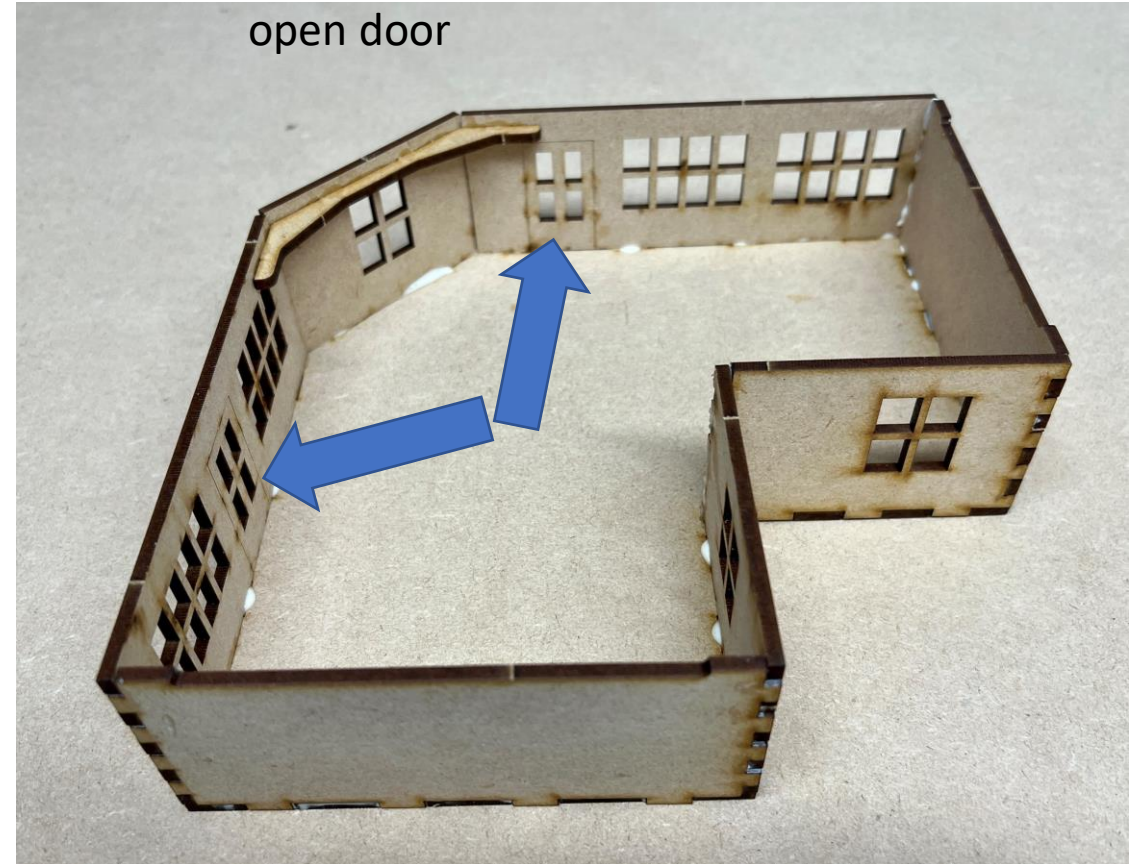
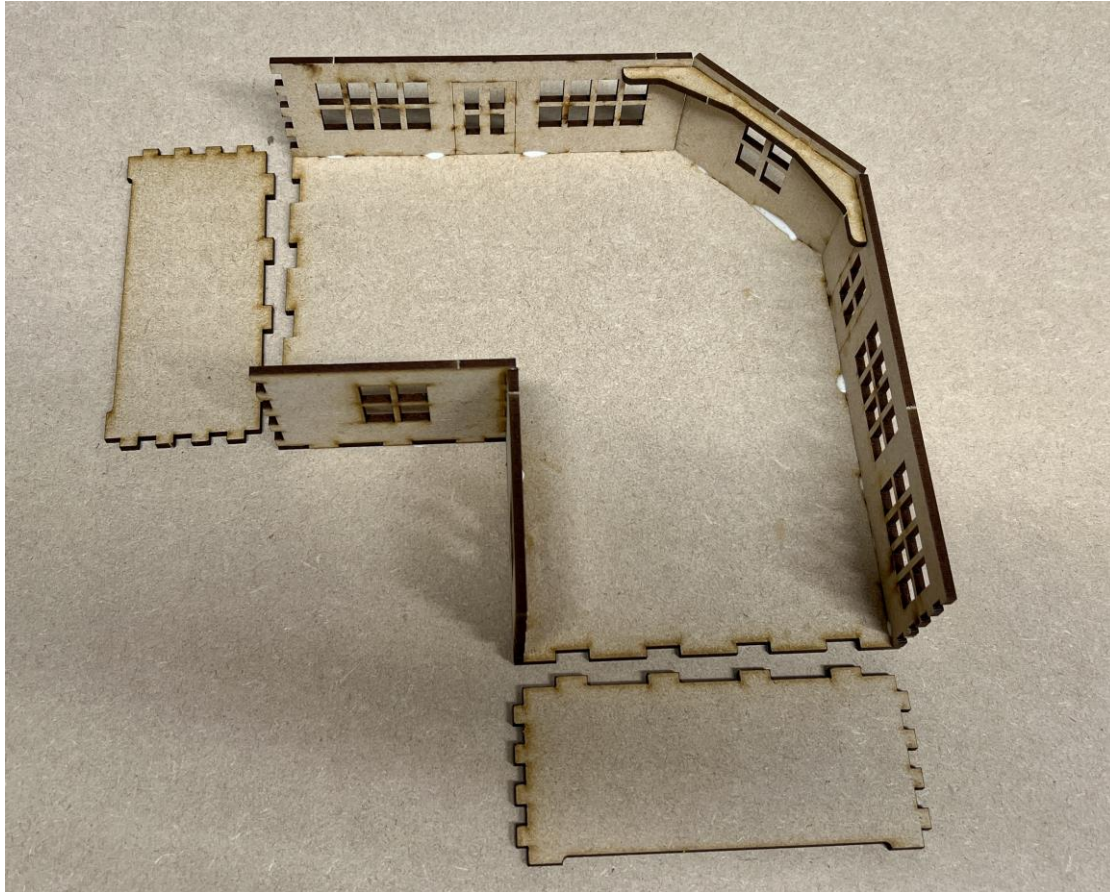



Upper Floors

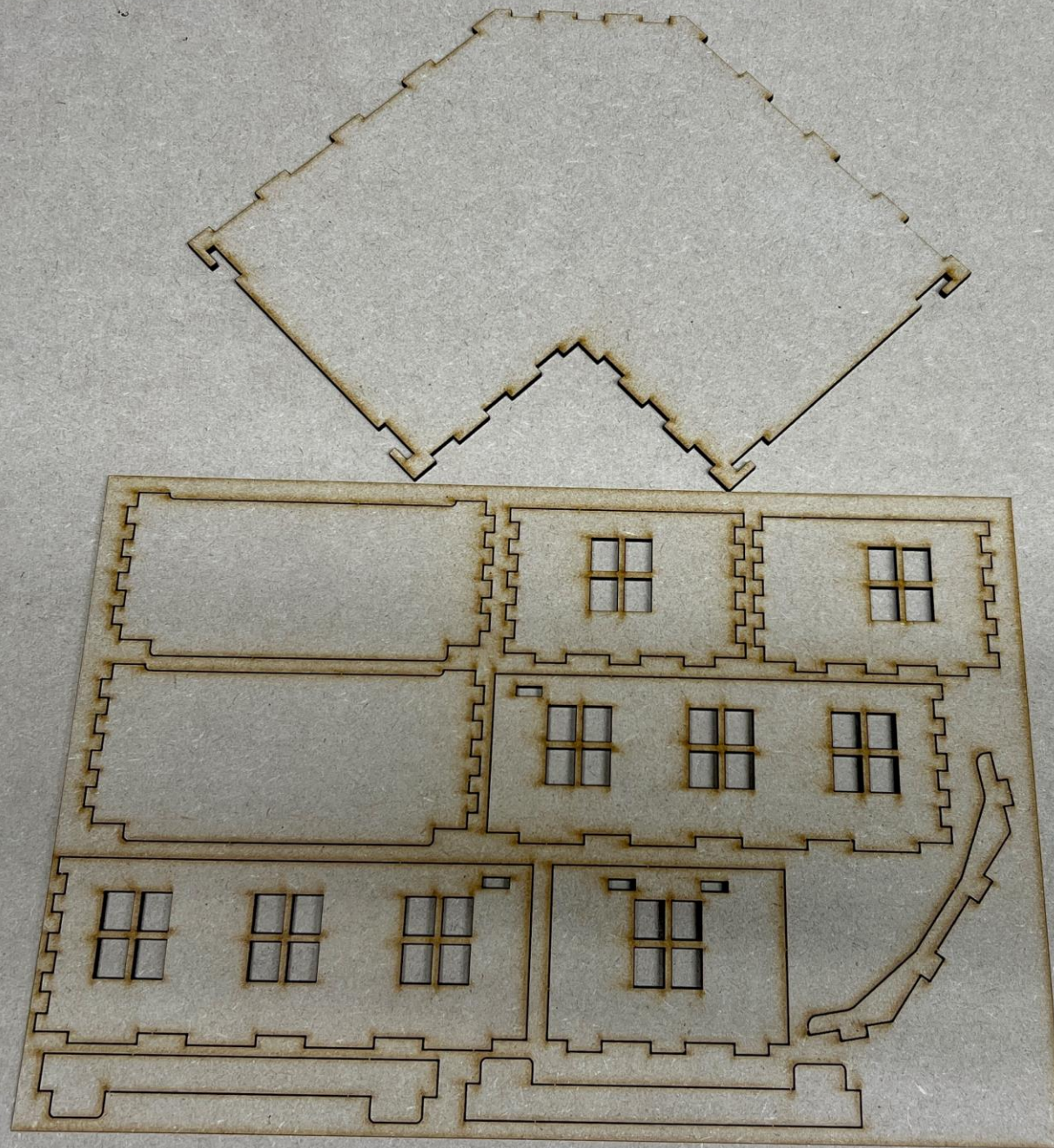



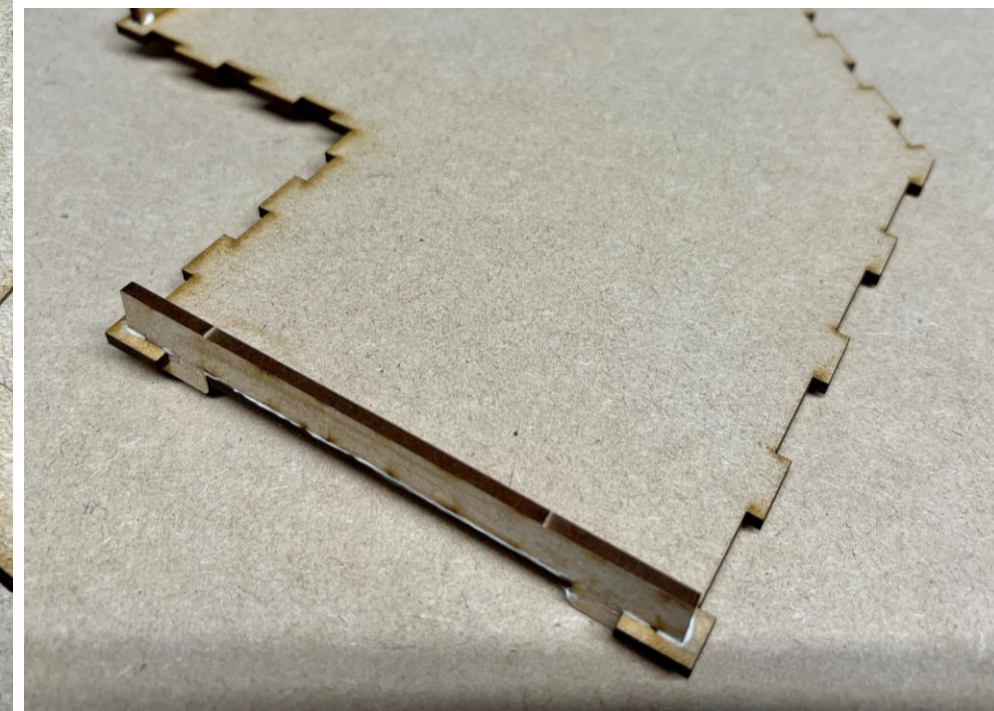
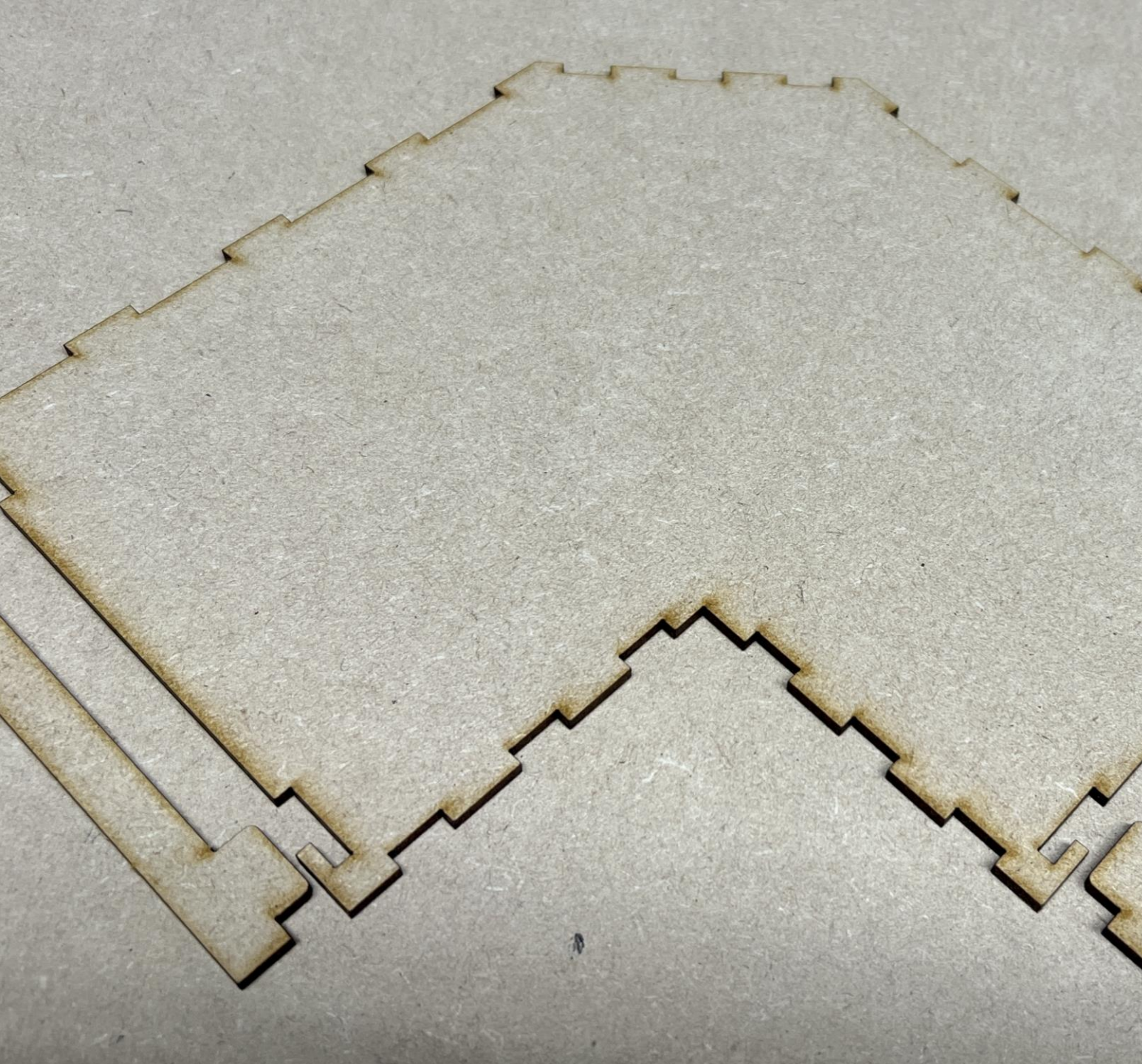



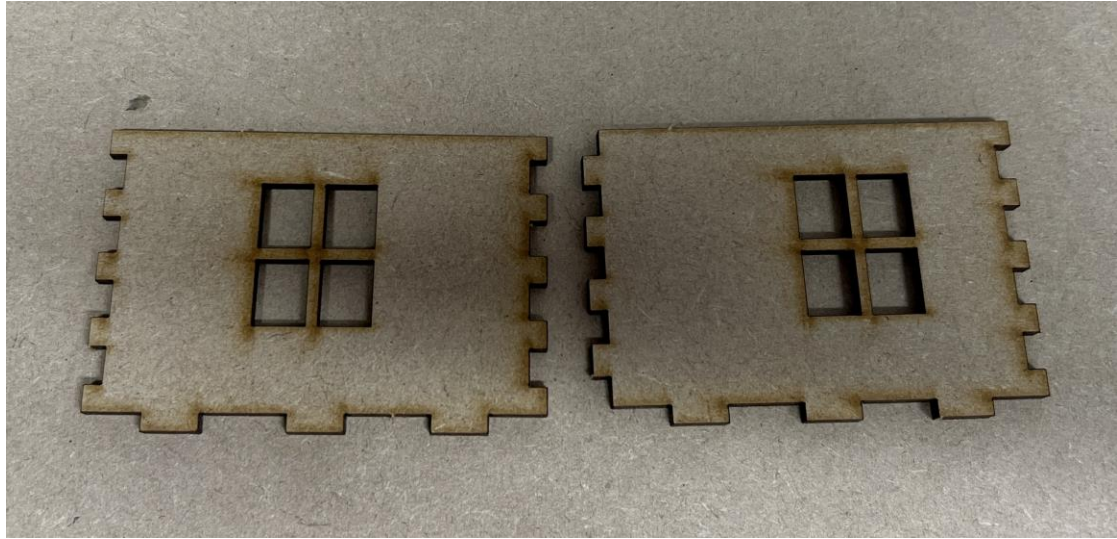







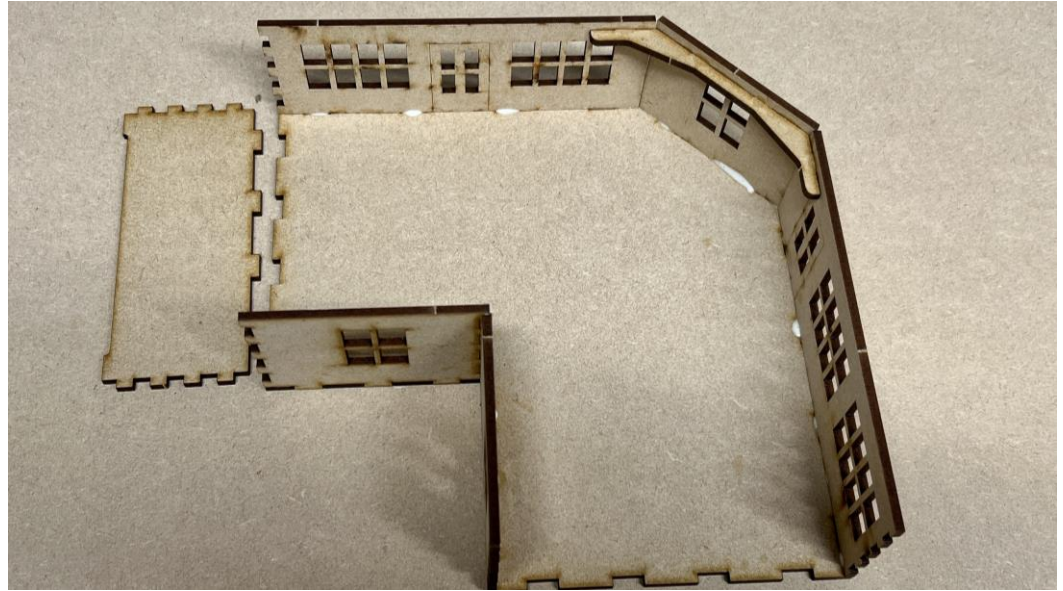



Roof

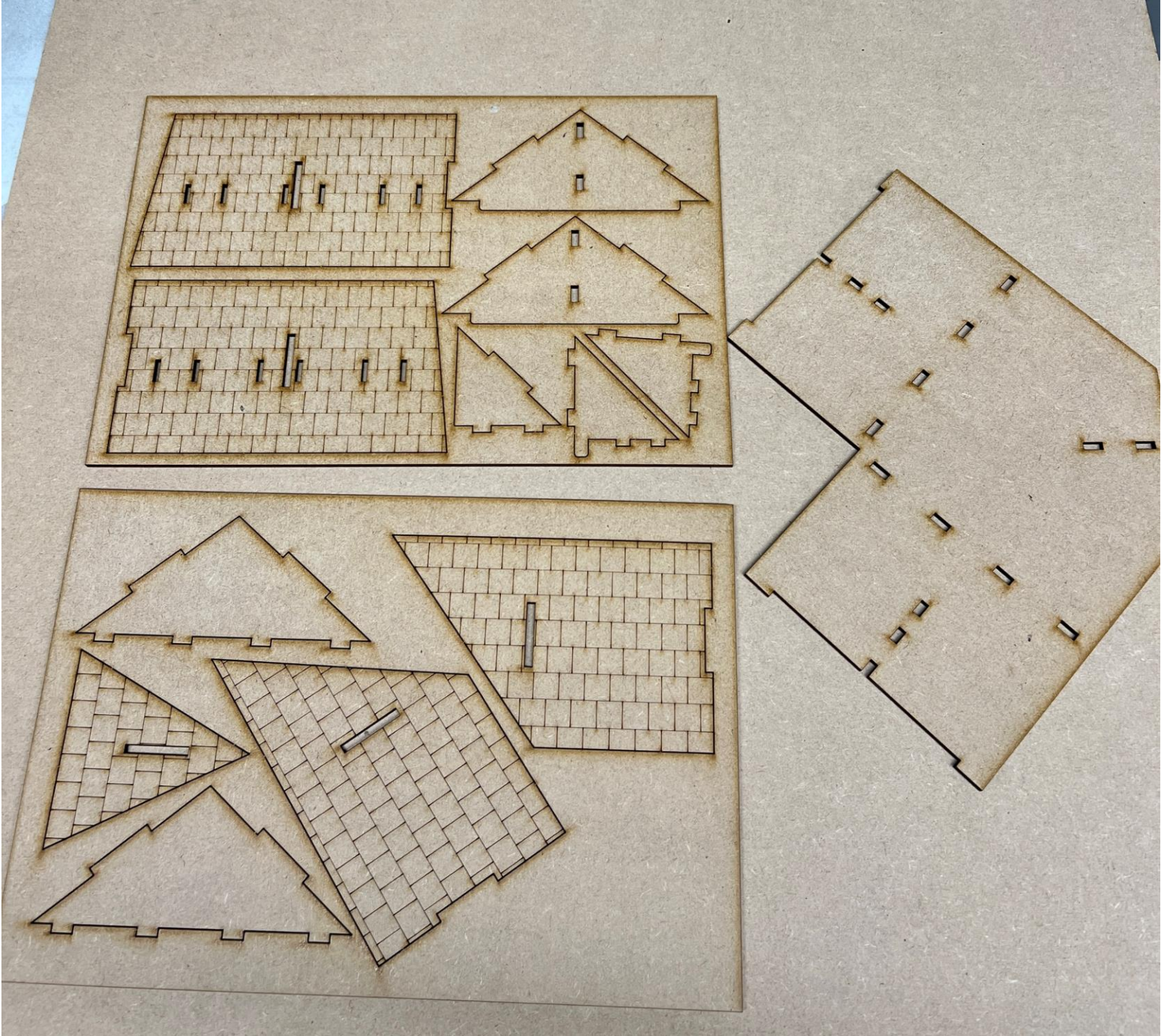



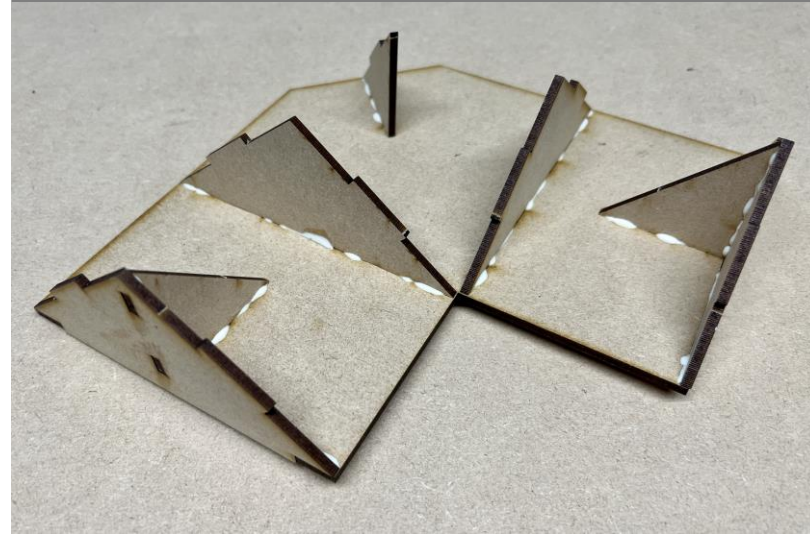
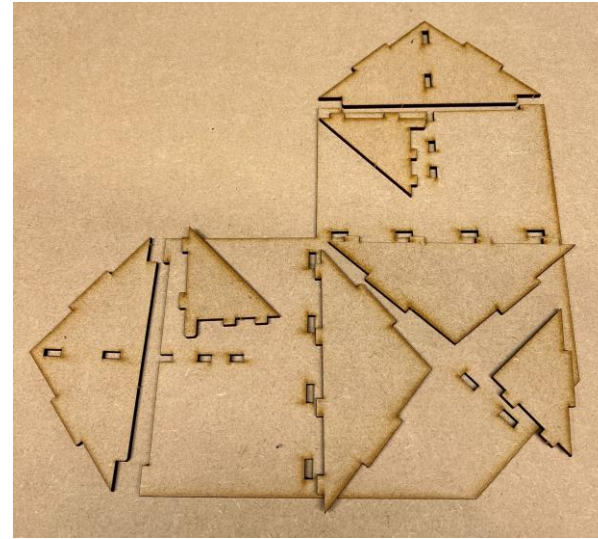
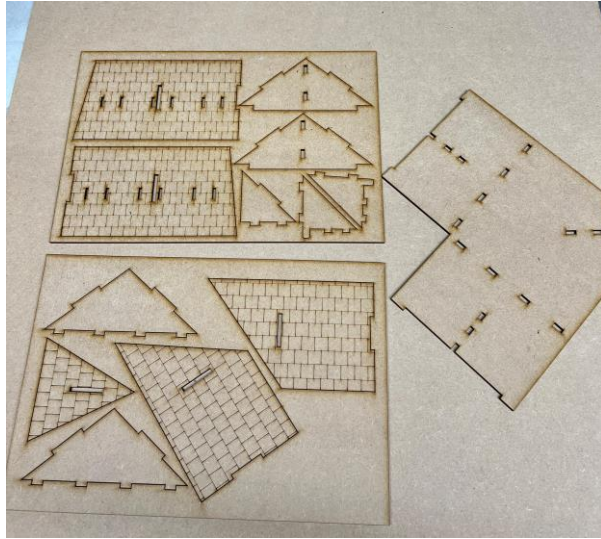



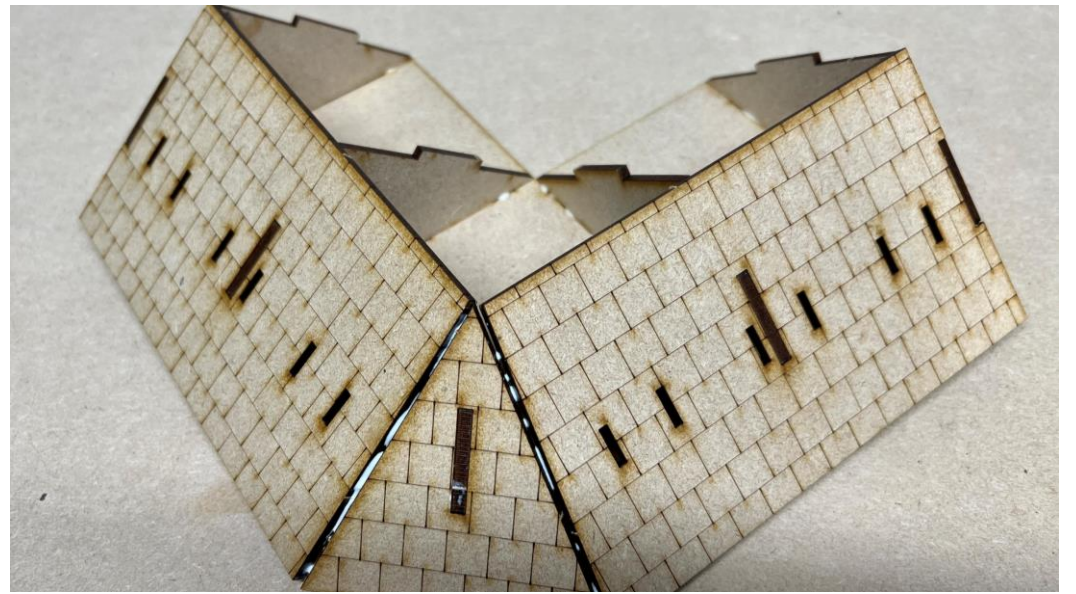
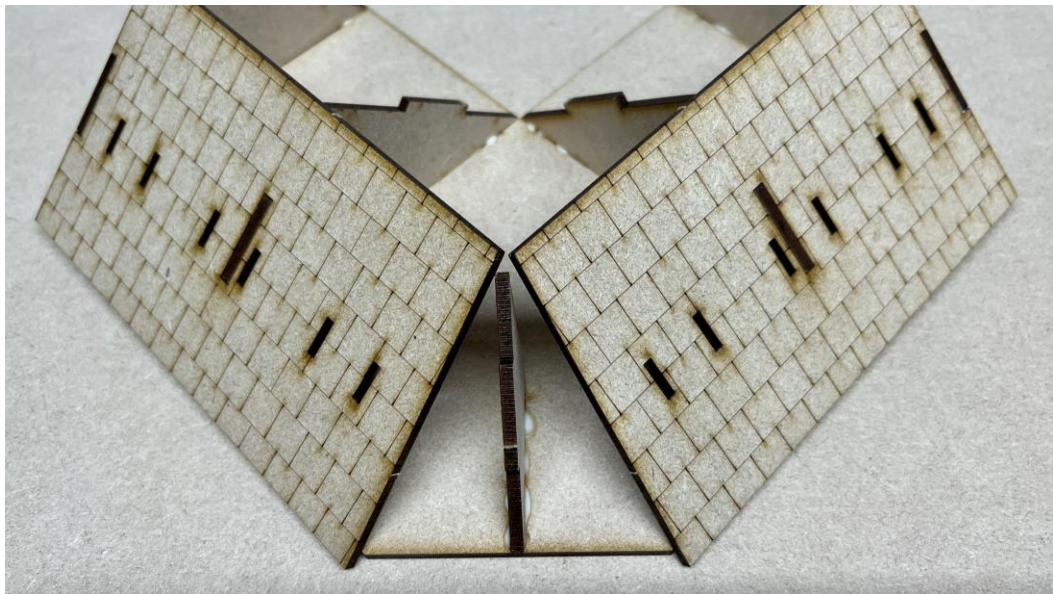
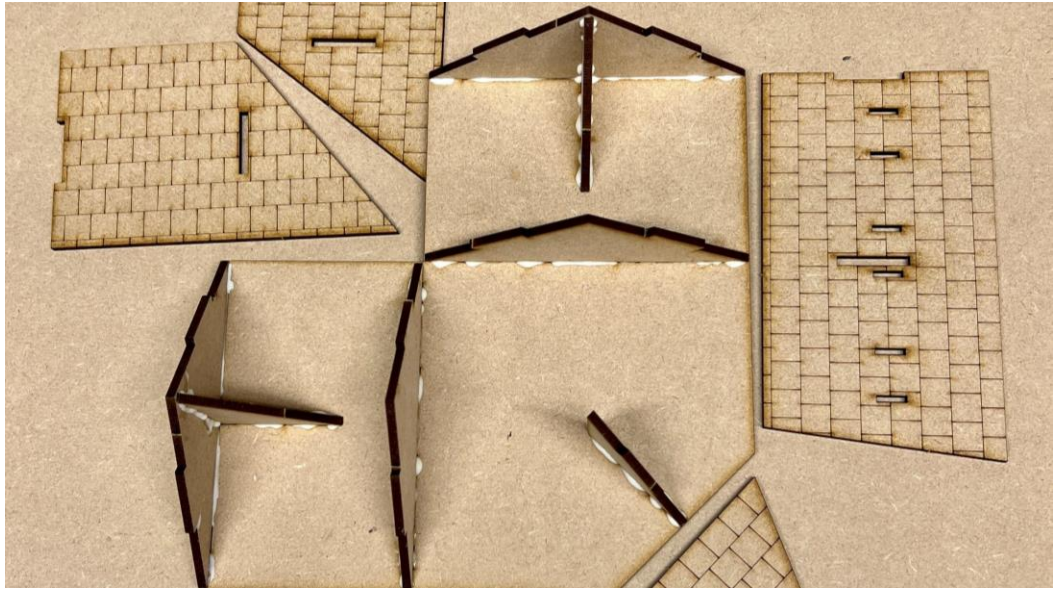



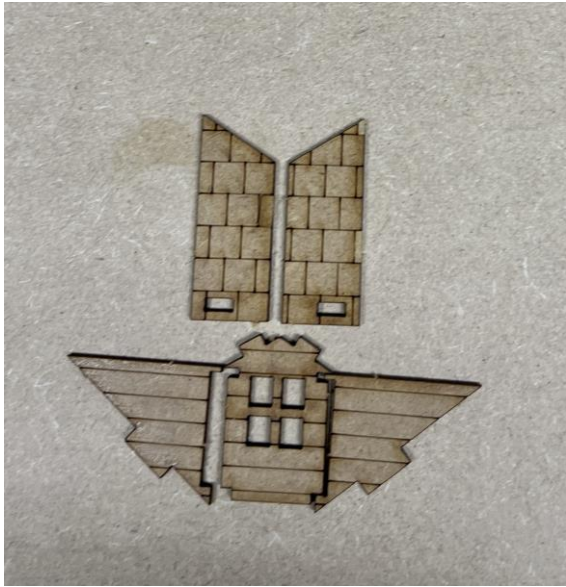
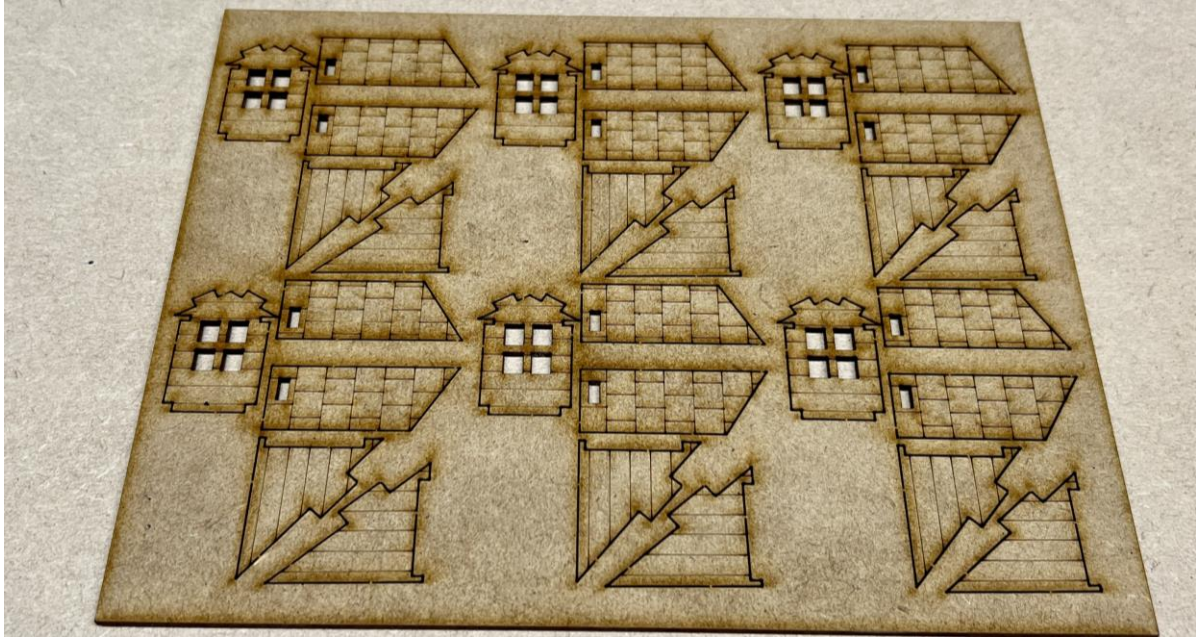

Glue all the supports in place & allow to dry

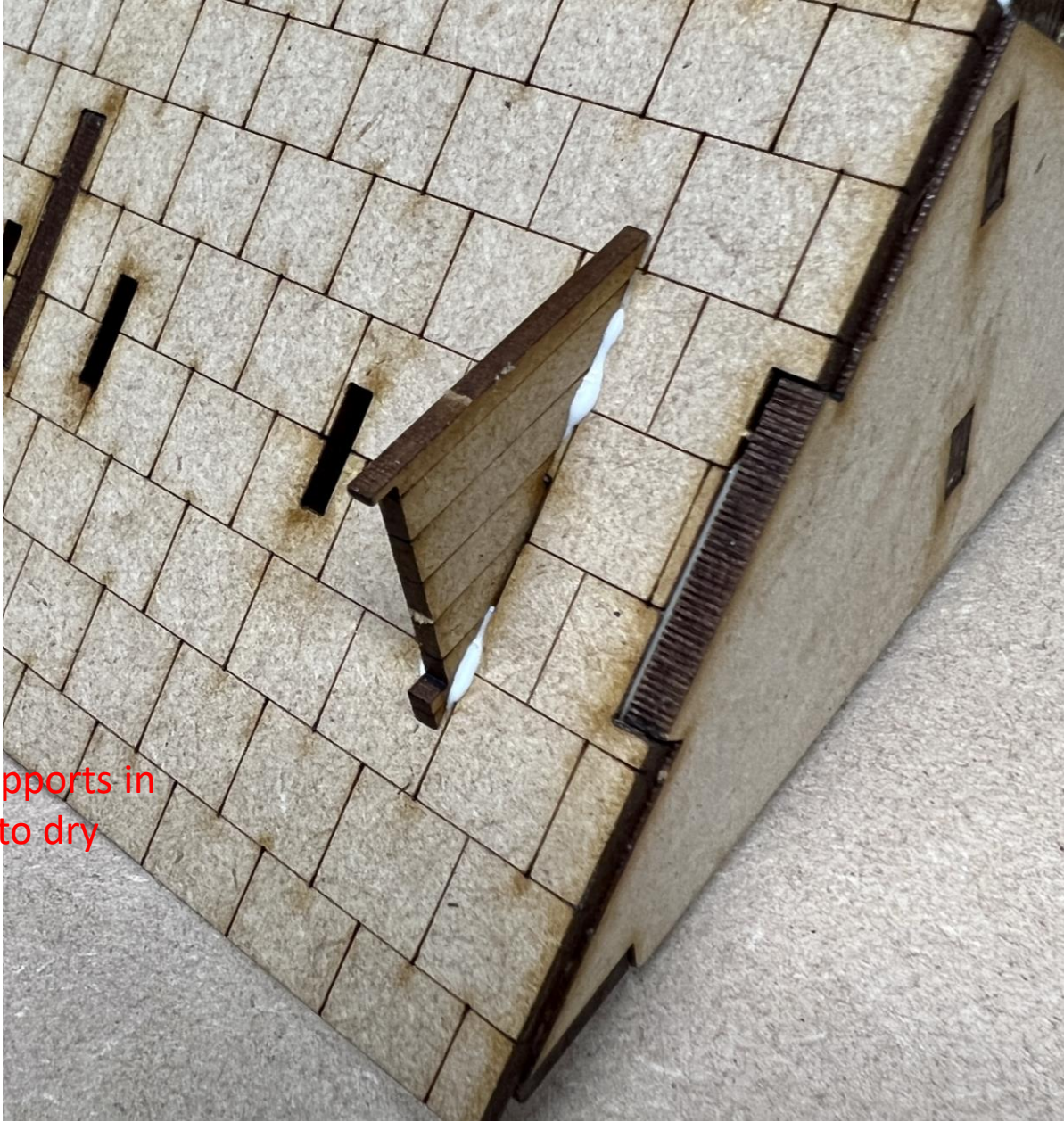



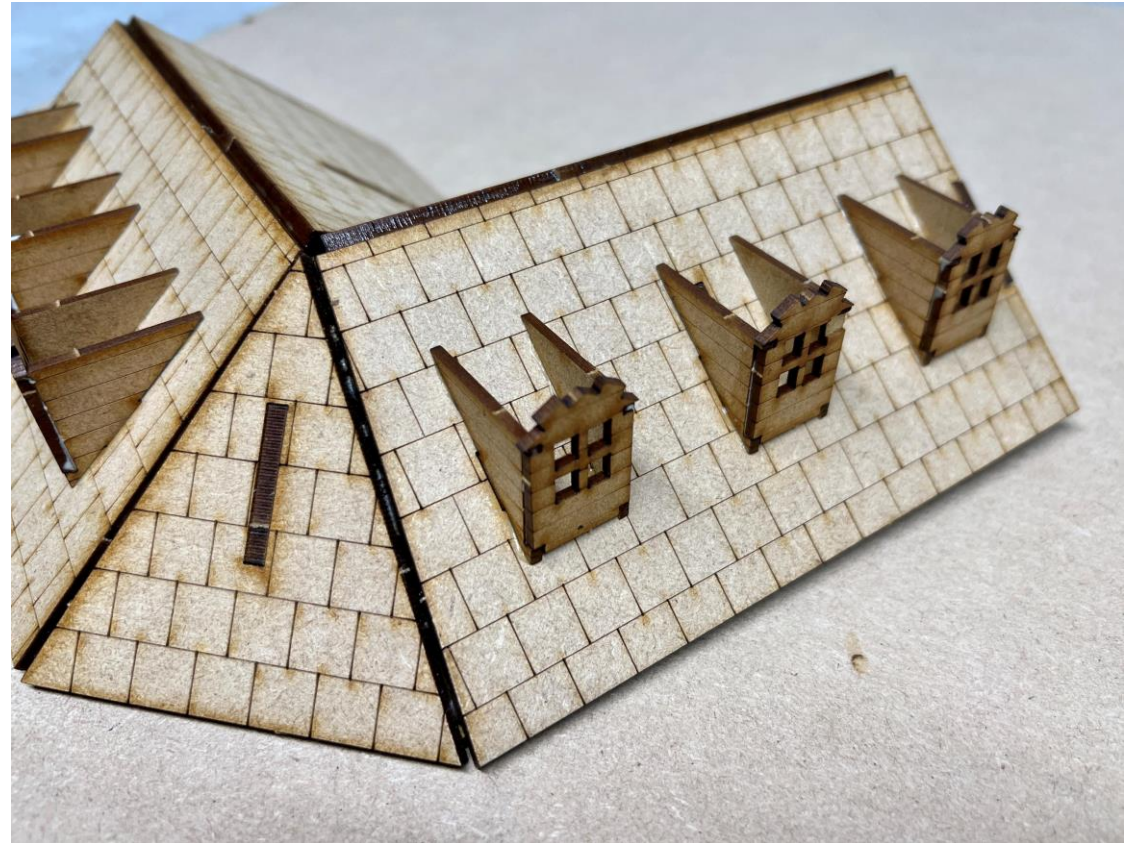



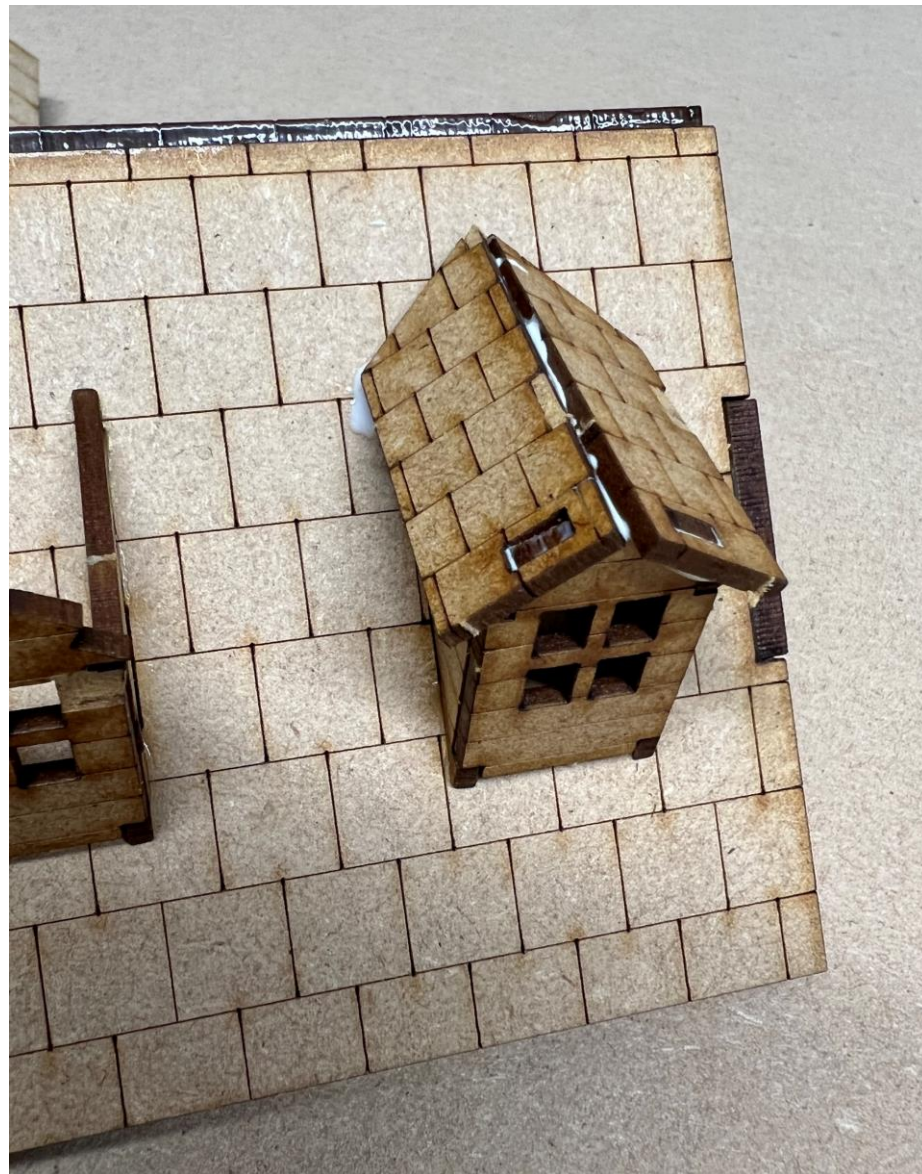



Use a craft knife to gently  
release frame tabs There are  
4 per frame

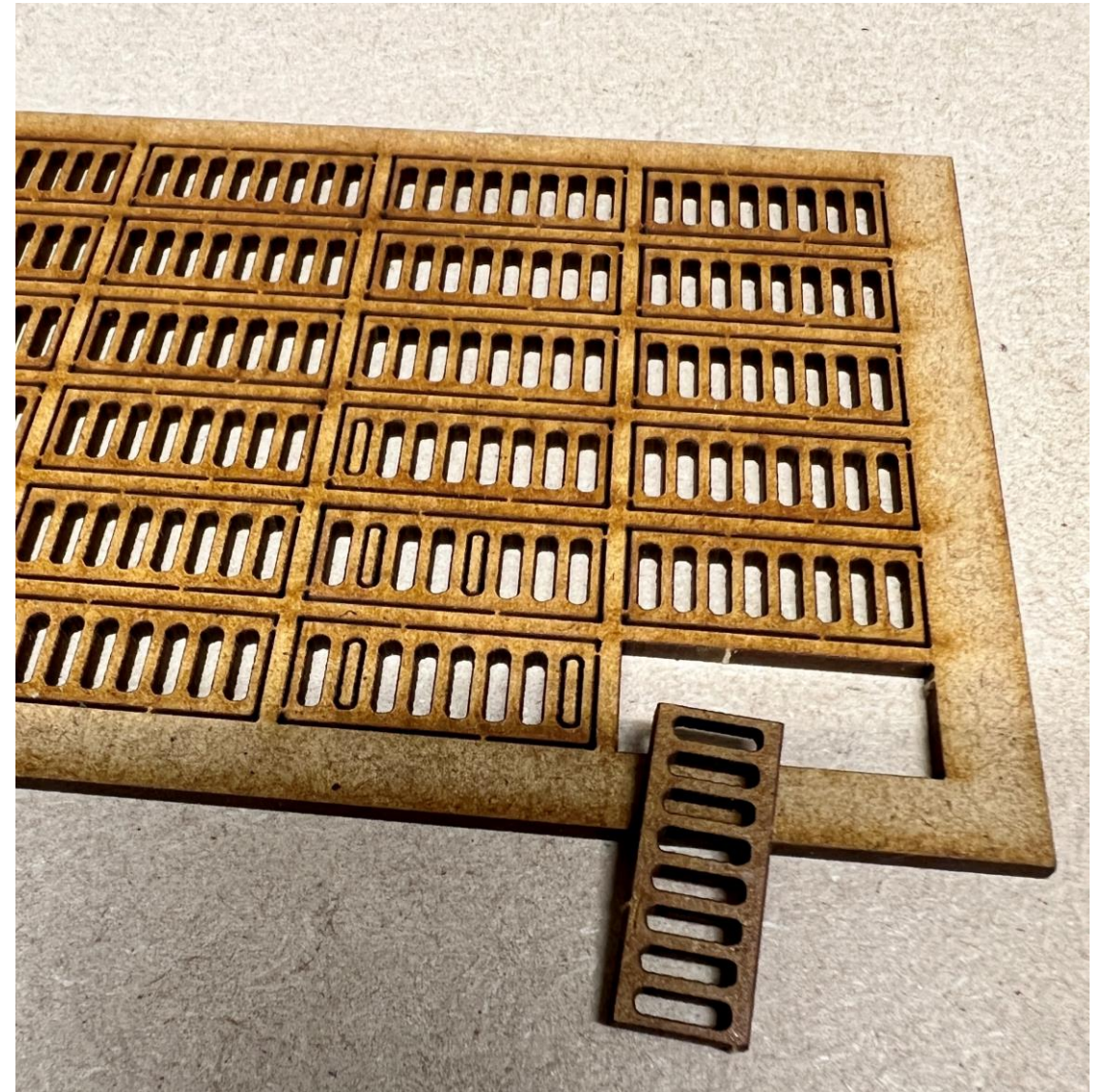
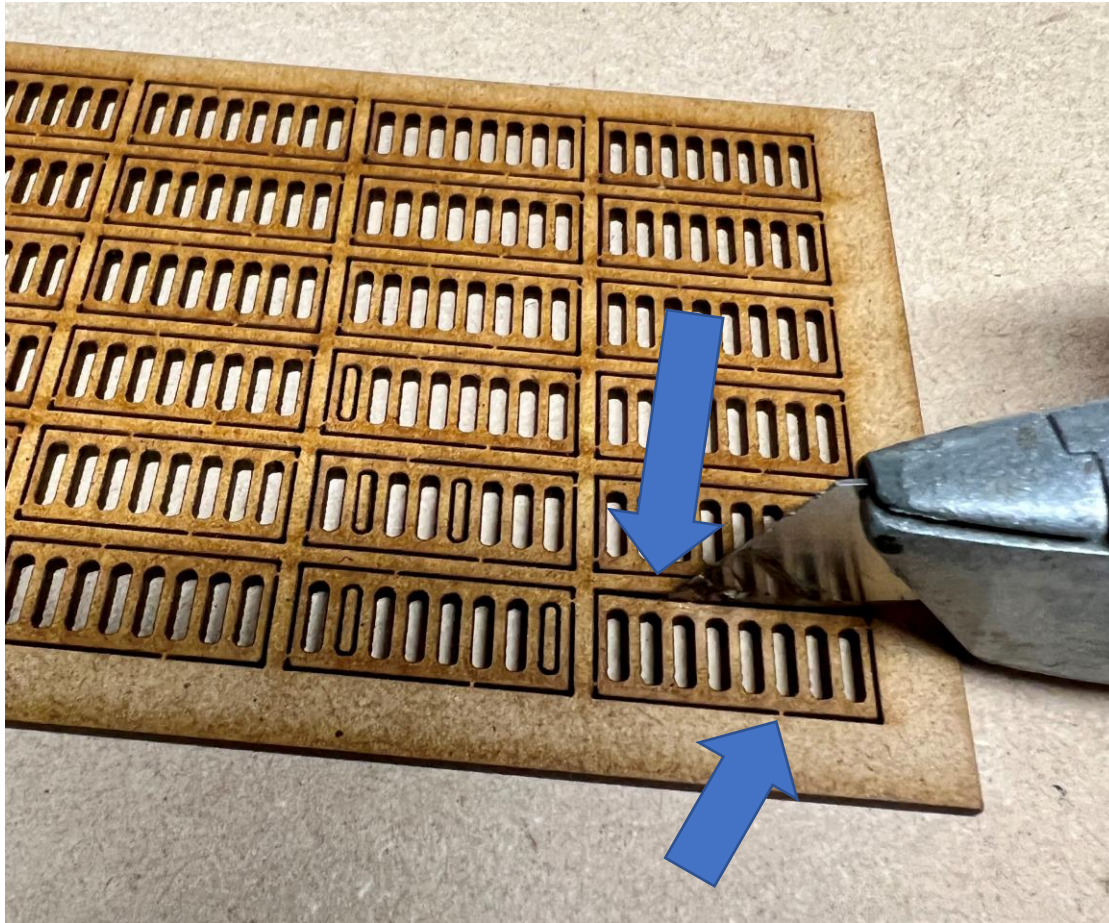



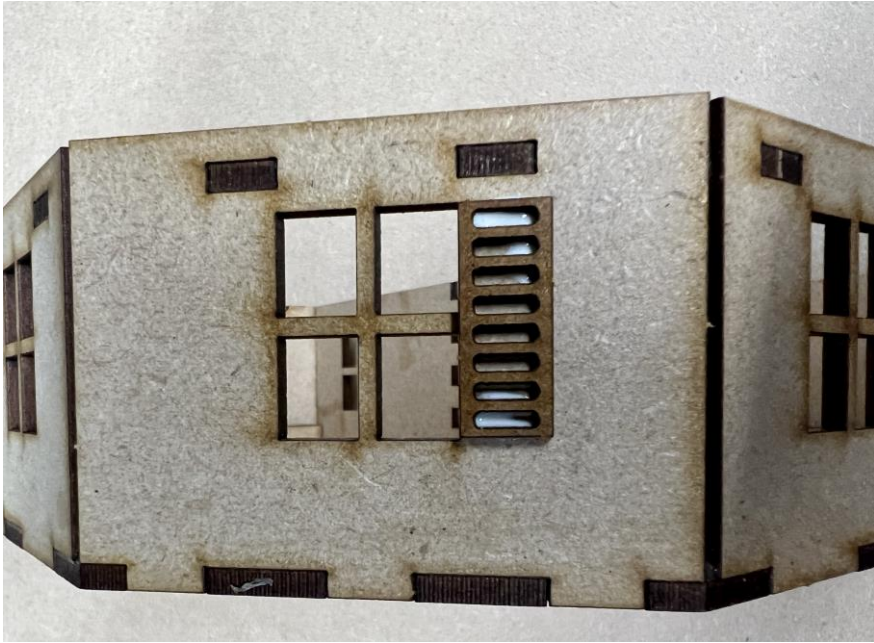

Glue the side blinds in  
place as required

---



